

James S. Russell

Part 2

Heirs of Asaph Churchill

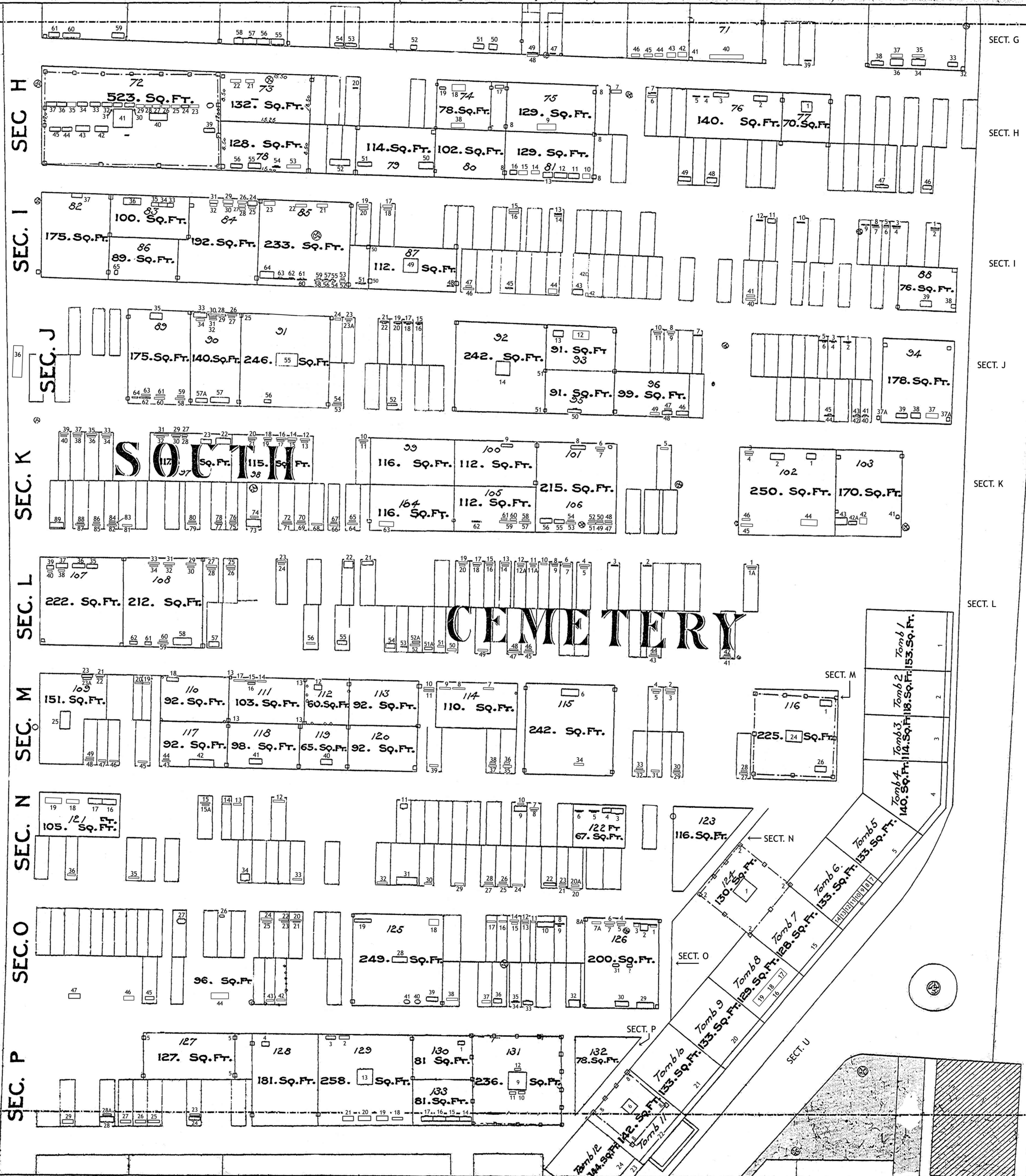

SOUTH

CEMETERY

TO USE MAP: First locate section letter on map. Then find small TYPED (not hand-written) number by rectangle or square shape. These are the numbers that correspond to the located number as assigned by the Historic Burying Grounds Initiative. Any larger hand-written numbers indicate OLD deed or plot numbers that are not used on the HGBI lists.

CITY OF BOSTON
SOUTH CEMETERY
 DORCHESTER
 May 24, 1900
William Johnson
 City Engineer

Scale 8 feet to an inch
 May 24, 1900
AREA 95462.Sq.Fr.

Revised 2011 by Kelly Thomas, Historic Burying Grounds Initiative